

## Guarantee & Aftercare

When installing or using tools, extra care must be taken to avoid damaging the finish or fitting. To maintain the appearance, please ensure it is cleaned regularly using a clean soft damp cloth only. Abrasive cleaners or detergents must not be used as they may cause surface deterioration. The company provides a guarantee against faulty material or manufacture excluding serviceable parts, providing they have been installed, cared for and used in accordance with our instructions.

## What you receive is whole unit, please.

1. Pre installed two G1/2 male connectors under the floor.
2. Prepare circular hole in the floor 100mm(4") minimum, 150mm(6") maximum, 75mm(3") deep.
3. Decorative floor.
4. Unscrew and take off lock nut (3), push decorative cover (1) onto the lower position of tube (2), then screw the lock nut (3) on to the thread as far as it will go.
5. Screw mounting flange (4) onto the tube.
6. Tighten screw the lock nut (3) on to the mounting flange (4).
7. Connect cold / hot inlet pipe to two G1/2 male connectors, which is water supply.
8. Use screws(5) and expansion screws(6) to fix Flange(4) on the floor.
9. Push the decorative cover (1) onto the floor.
10. Outlet pipe insert to Tube(2), tighten screw Screw nut (9) by hand (Noted, two plastic washer (10) don't miss).
11. Fit the hose (15) to the outlet pipe, and the handset (12) to the hose, ensuring sealing washers(13) are in place.
12. Open water supply and check if any leaks before use.

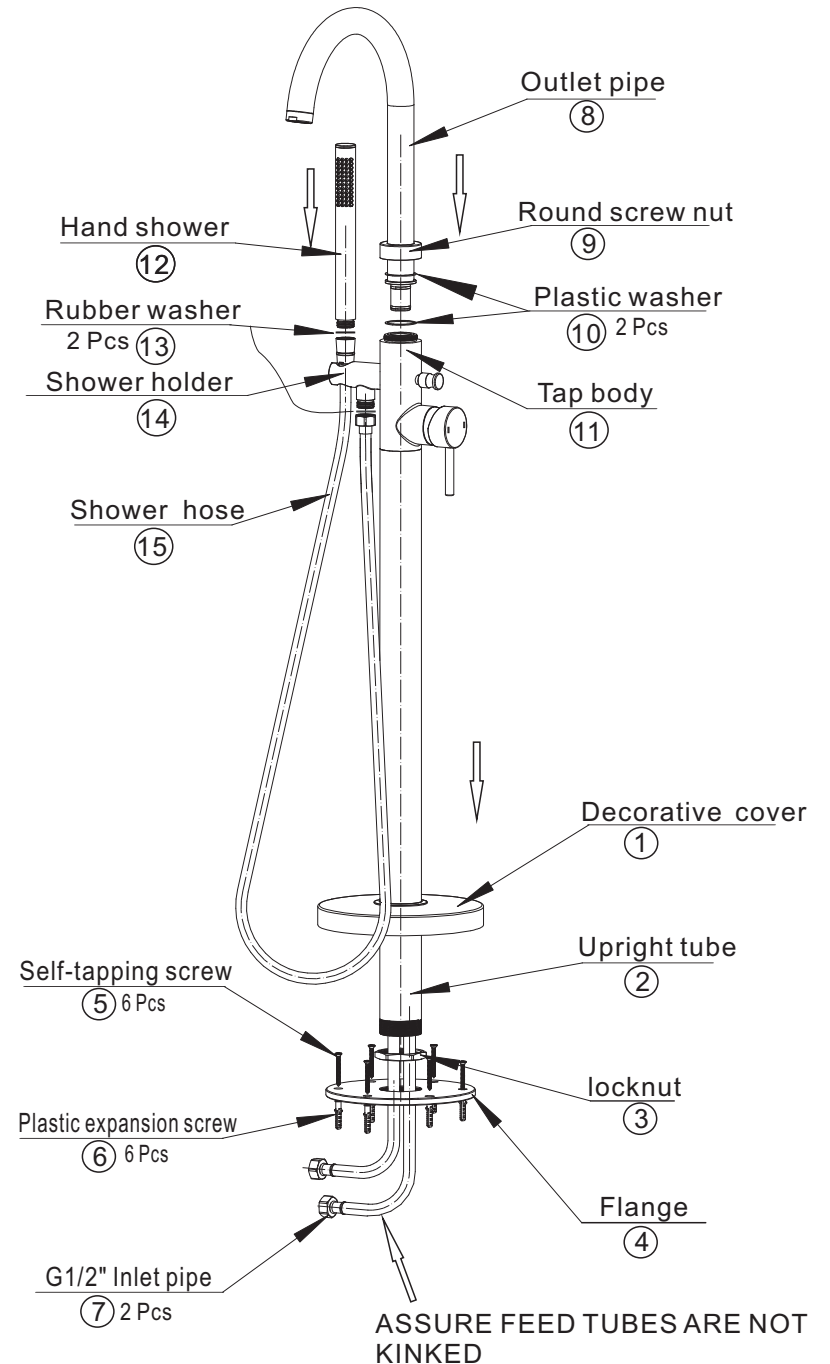

Victorian Plumbing

Diamond House.41, Stephenson Way. Formby Business Park Formby. England. L37 8EG

Tel: 0044 800 862 0878

Website: [www.victorianplumbing.co.uk](http://www.victorianplumbing.co.uk)